

Installation Instructions for Filter Cartridges of GC, GCX and Dental Series Air Purifiers

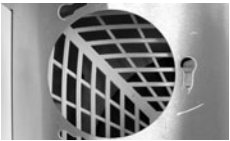

Table of Contents

	Chapter 1	Preparing the Cartridges for Insertion	2
	Chapter 2	Opening the IQAir Air Purifier	2
	Chapter 3	Inserting Cartridges into "Sawblade"-Type Plate	3
	Chapter 4	Inserting Cartridges into "Keyhole"-Type Plate	3
	Chapter 5	Closing the IQAir Air Purifier	4

Chapter 1 – Preparing the Cartridges for Insertion



Pull a post-filter sleeve over each of the cartridges. With new IQAir systems the sleeves are supplied inside of the IQAir System (refer to Chapter 2 on how to open the IQAir System).



Chapter 2 – Opening the Air Purifier



Pull the first locking arm outward to release the arm from its snap-in position in the diffuser. Disengage the other arm the same way.

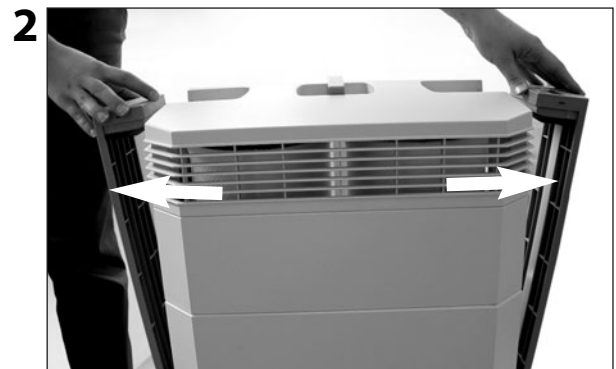

Pull both locking arms outwards evenly until they snap into place and remain open.



Remove the diffuser and the top two (GCX top four) frame elements.

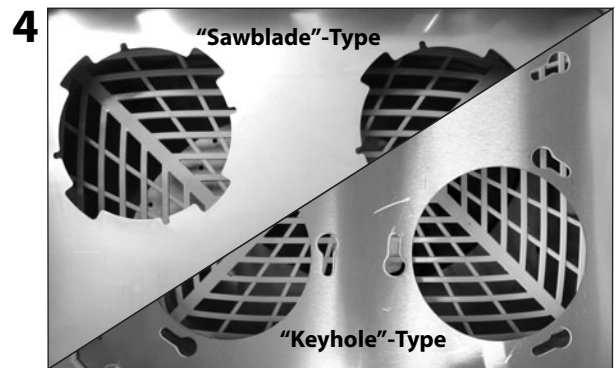

You will find either a "Sawblade"-Type or "Keyhole"-Type plate within the bottom frame element. Follow the appropriate instructions for your plate type.

Chapter 3 – Inserting Cartridges into the “Sawblade”-Type Plate



For the “Sawblade”-Type plate...

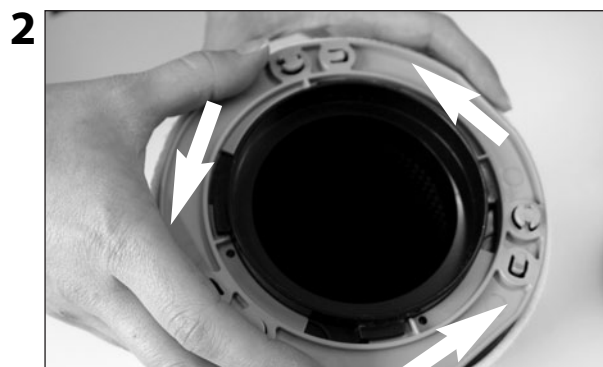

...use the cartridge **without** the grey adapter ring. If the ring is pre-fitted to the cartridge, turn the ring counter-clockwise...



...and lift it off the cartridge. (The grey adapter ring will not be needed and can be disposed of.)



Turn the cartridge around and insert it into one of the plate slots. Turn the cartridge clockwise until it is securely locked onto the plate. Repeat steps 2 – 4 with remaining cartridges. Proceed to Chapter 5.

Chapter 4 – Inserting Cartridges into the “Keyhole”-Type Plate

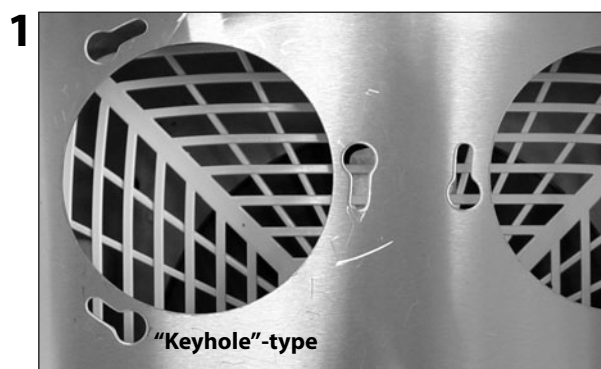

For the “Keyhole”-Type plate...



...use the cartridge **with** the grey adapter ring in place.



The cartridge with the grey adapter ring can then be inserted into the keyhole slots in the plate.



Once inserted into the slots, turn the cartridge clockwise until it is securely locked onto the plate. Repeat steps 2 – 4 with the remaining cartridges, then proceed to Chapter 5.

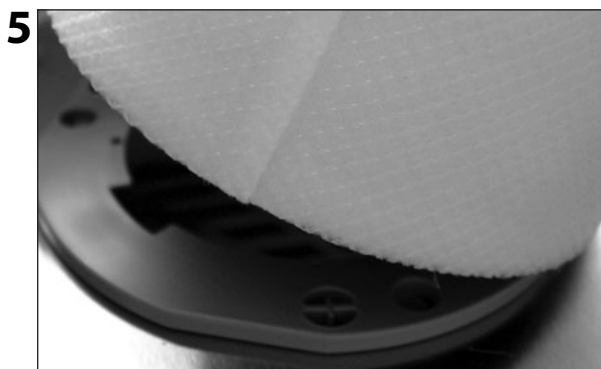

Note: If you remove the cartridge again, the grey adapter ring will stay locked on the plate.



Since the grey adapter ring has now become an integrated part of the plate, no additional adapter rings will be needed for future replacement of cartridges.

Chapter 5 – Closing the IQAir System



Refit the housing element with the inserted cartridges onto the IQAir System...



...replace the remaining housing element(s) and the diffuser. Close the two locking arms simultaneously until they securely lock into the diffuser.

IMPORTANT: When used cartridges have been replaced with new cartridges, the appropriate filter life monitor must be reset in the IQAir's control panel. Refer to the IQAir user manual for instructions.